

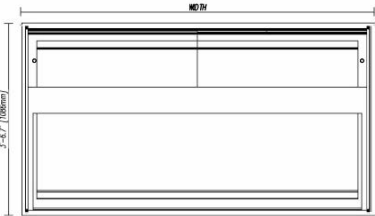

T-Line

Case Features:

- Combo Units - offering 3 options in Grab n Go Service Units -Refrigerated Top and Bottom option Refrigerated and Ambient/Dry Top section.
- Combo offers Double Pane Anti -Condensation Glass with Vertical fixed front & side UV bonded Frameless Glass and Rear Sliding Doors
- Stainless Steel Interior finish
- Modern, Jewelry Case Style design
- Custom color design and finishing options for case panels
- LED light technology enhances presentation
- Frozen Dessert Model Available, Call for More Information



Top

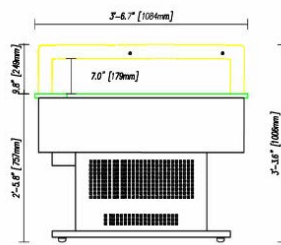

T-Form

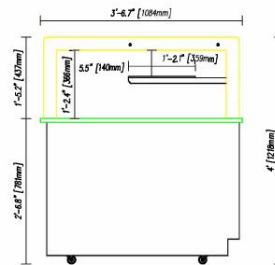

High Glass

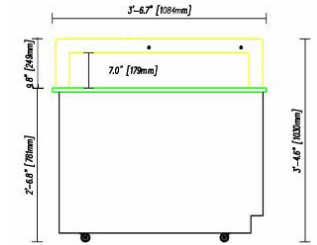

Low Glass

DISPLAY CASES

Type	Model	Width	Depth	Height High Low	Electrical Requirements
T-Form Pastry Display Case	T-1500TF	59.5" (1500mm)	43" (1087mm)	39.5" (1003mm)	220V/1Phase/60Hz/10amps
	T-1800TF	71" (1800mm)	43" (1087mm)	39.5" (1003mm)	220V/1Phase/60Hz/10amps
	T-2000TF	79" (2000mm)	43" (1087mm)	39.5" (1003mm)	220V/1Phase/60Hz/10amps
	T-2200TF	87" (2200mm)	43" (1087mm)	39.5" (1003mm)	220V/1Phase/60Hz/10amps
Pastry Display Case	T-1000P	39.5" (1003mm)	43" (1087mm)	39.5"(1003mm) 48"(1219mm)	220V/1Phase/60Hz/10amps
	T-1500P	60" (1524mm)	43" (1087mm)	39.5"(1003mm) 48"(1219mm)	220V/1Phase/60Hz/10amps
	T-1800P	71" (1803mm)	43" (1087mm)	39.5"(1003mm) 48"(1219mm)	220V/1Phase/60Hz/10amps
	T-2000P	79" (2007mm)	43" (1087mm)	39.5"(1003mm) 48"(1219mm)	220V/1Phase/60Hz/10amps
	T-2200P	87" (2210mm)	43" (1087mm)	39.5"(1003mm) 48"(1219mm)	220V/1Phase/60Hz/10amps
Freezer (No Shelf/Only Base)	T-1000F	39.5" (1003mm)	43" (1087mm)	39.5" (1003mm)	220V/1Phase/60Hz/20amps
	T-1300F	51.5" (1308mm)	43" (1087mm)	39.5" (1003mm)	220V/1Phase/60Hz/20amps
	T-1500F	59.5" (1511mm)	43" (1087mm)	39.5" (1003mm)	220V/1Phase/60Hz/25amps
	T-1800F	71" (1800mm)	43" (1087mm)	39.5" (1003mm)	220V/1Phase/60Hz/30amps
	T-2000F	79" (2007mm)	43" (1087mm)	39.5" (1003mm)	220V/1Phase/60Hz/30amps
	T-2200F	87" (2210mm)	43" (1087mm)	39.5" (1003mm)	220V/1Phase/60Hz/30amps

All technical data, pictures and drawings contained in this document are not binding on the manufacturer, nor can the manufacturer be held liable for any modification of the machine, in part or in whole.



35 Trade Zone Court ▪ Ronkonkoma, NY 11779 ▪ www.gtidesigns.com
 Phone 631.981.2100 ▪ Fax 631.981.3509 ▪ CustomerService@gtidesigns.com